

Transport Dimensions

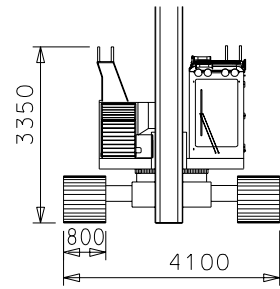

Maximum track width.

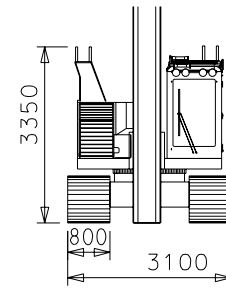

Minimum track width.

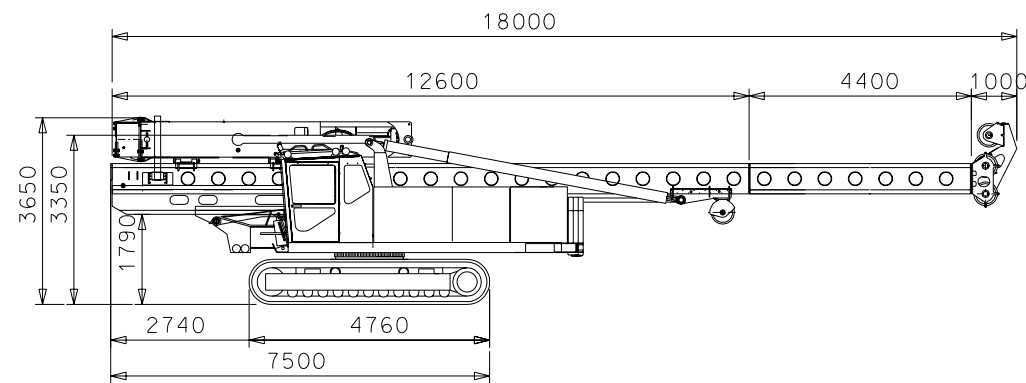

PM 20 + HHK-5A hammer transport dimensions with the standard leader length.

JUNTTAN

JUNTTAN OY, Leväsentie 2, FIN-70700 KUOPIO, FINLAND
Mail Address P.O. Box 1702, FIN-70701 KUOPIO, FINLAND
Tel: +358 17 287 4400, Fax: +358 17 287 4411
www.junttan.com junttan@junttan.com

DATA SHEET

JUNTTAN

PM 20 Hydraulic Pile Driving Rig

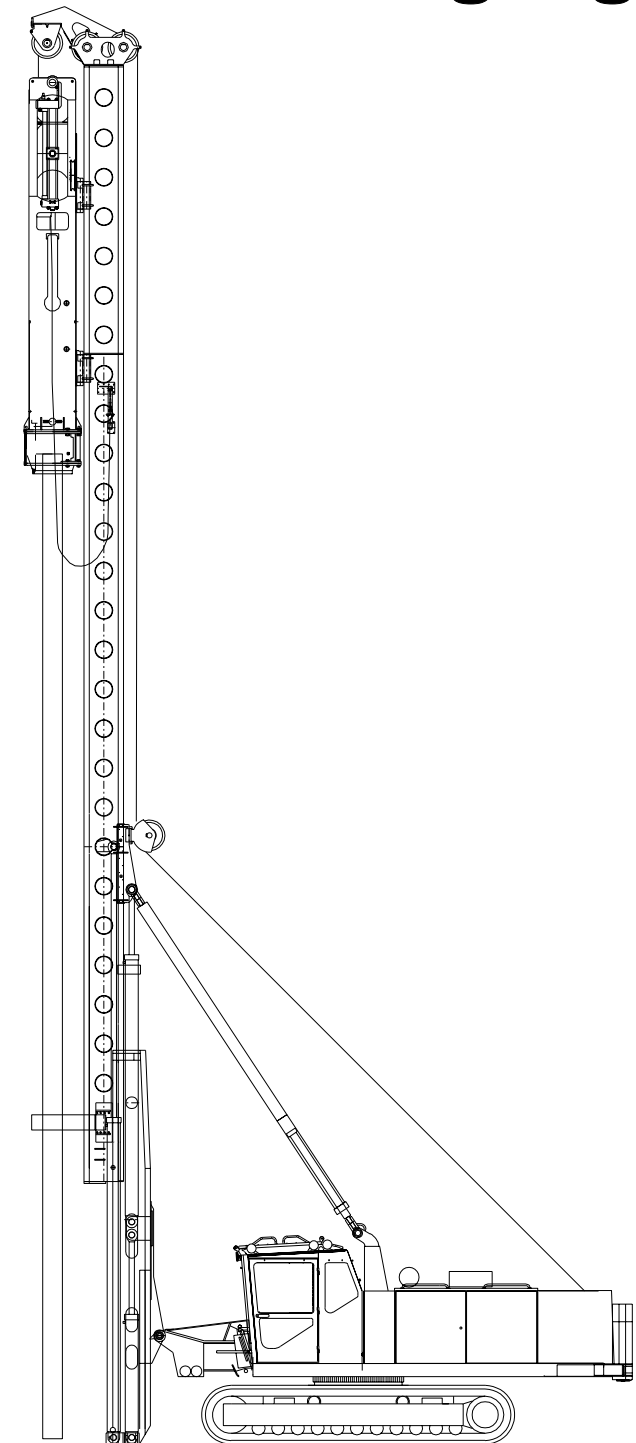

JUNTTAN PM 20

Junttan has a comprehensive range of hydraulic multipurpose piling rigs. Many ingenious details of the Junttan rig provide ease of transport, excellent stability, quick and safe pile handling, precise inclinations and top pile driving performance. Junttan PM 20 is the basic model of the range, and can be adapted to for driven, bored or vibrated piles simply by changing the tool equipment. This brochure presents PM 20 rig equipped for driven piling.

Design Benefits of Junttan Rigs

- self erecting leader
- leader horizontal movement
- expandable tracks
- powerful winches
- low centre of gravity
- hydraulic system adaptable to different equipment e.g. hammers and rotary drives
- low transportation height

Base Machine Junttan PM 20

Leader (telescopic leader, self-erection) Length - fixed leader (12,6+4,4 m) - telescopic movement - effective length - with extra 2m extension (optional, see page 3) - cathead height Vertical movement up down Horizontal movement max Hydraulic pile arms on leader Electronic leader inclination meter Max. load on the leader (pile + hammer) and inclinations according to a separate capacity table	17 m 4 m 21 m 23 m 1 m 1000 mm 500 mm 1500 mm
Winches (single line pull, 1. layer) Main winch (hammer) Aux. winch (pile) Aux. winch II (optional, see page 3)	10 ton 8 ton 5 ton
Engine Cummins QSB5.9	179 kW
Fuel tank	600 litres
Hydraulics Oil flow max Pressure max	2 x 160 l/min + 86 l/min 300 bar
Undercarriage (hydraulic extension) Transport width Working width Crawler length Width of track shoes Counterweight - 6000 kg - hydraulically movable 1,5 m	3100 mm 4100 mm 4760 mm 800 mm
Weight Excluding: hammer and any optional equipment	46000 kg

Hydraulic Hammers for PM 20 (examples)

(for more information please see Junttan hammer catalogue)

Models	HHK-5	HHK-5AL	HHK-5A
Max. energy (kNm)	60	60	60
Max. stroke (m)	1,2	1,2	1,2
Blows per minute, adjustable	30-100	40-100	40-100
Ram weight (kg)	5000	5000	5000
Total weight (kg) including drive cap	7400	7900	8700

Examples of optional equipment for PM 20

(optional equipment increase the total weight)

Stabilizers (rear legs) Leader extra extension piece Additional winch (Aux. winch II) Pre-drill guides and JD3 side auger Side cathead Flat track shoes Tipping cabin Air conditioning for cabin Energy measuring device for hammer	2 m 5 ton torque 3 t/m tipping angle 15°
---	---

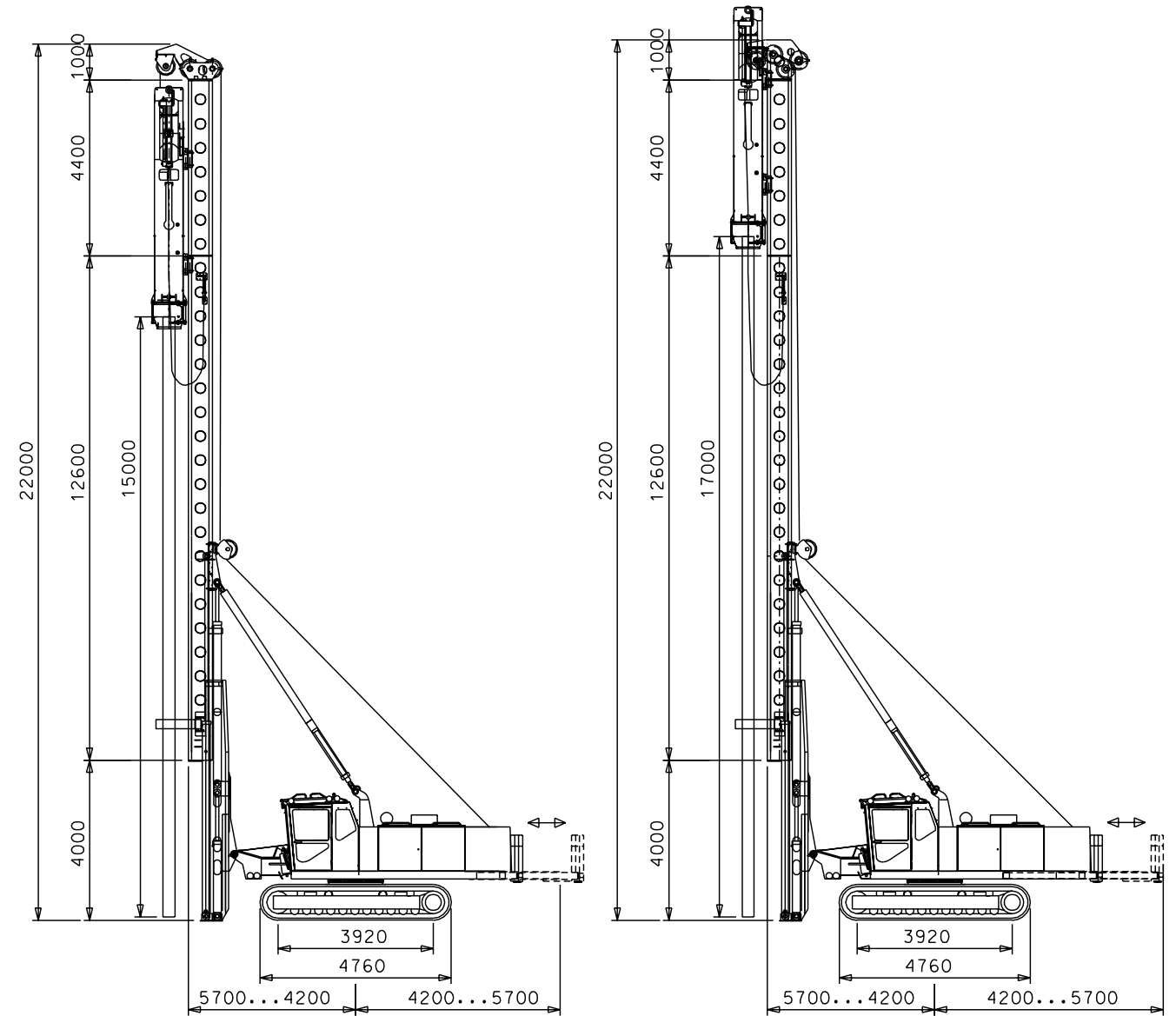

PM 20 + HHK-5A hammer with a standard cathead. (Working weight about 54700 kg)

PM 20 + HHK-5A hammer with a side cathead. (Working weight about 55200 kg)